



SRT Marine  
System Solutions

www.srt-marinesystems.com  
support@srt-marinesystems.com

201-0621:4

# Chronos Sensor Interface

## QUICK-START GUIDE



For full instructions of how to install and use your Chronos Sensor Interface please refer to the Installation and Operation Manual which can be found on the CD provided with the product.



The Chronos Sensor Interface can only be used when connected to a Chronos AIS AtoN Transceiver.

### What's in the box?

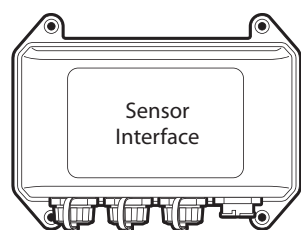

Sensor Interface

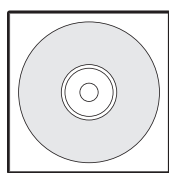

Product CD



Quick Start Guide



Connectors (x2)

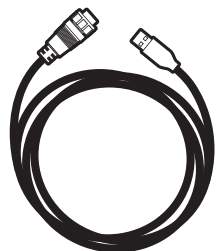

USB configuration cable

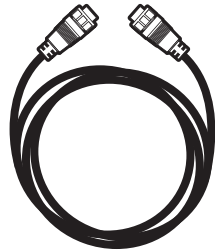

Link cable



Fixings

### What do I need?

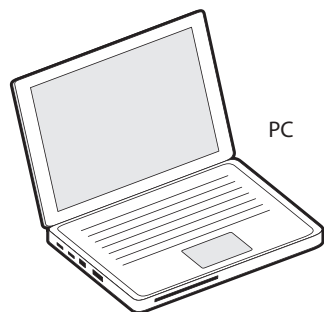

PC



Pozidriv (PZ2)  
screwdriver



M4 spanner

Length of cable  
(Diameter of 6.5mm to  
9.5mm, maximum of 18 cores)

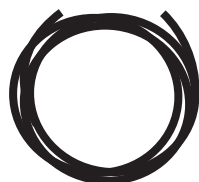

Connected Chronos  
transceiver unit

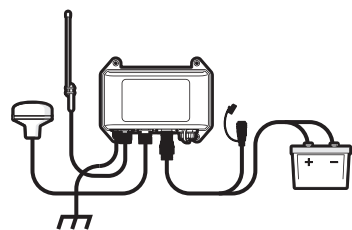

### Chronos Sensor Interface connections

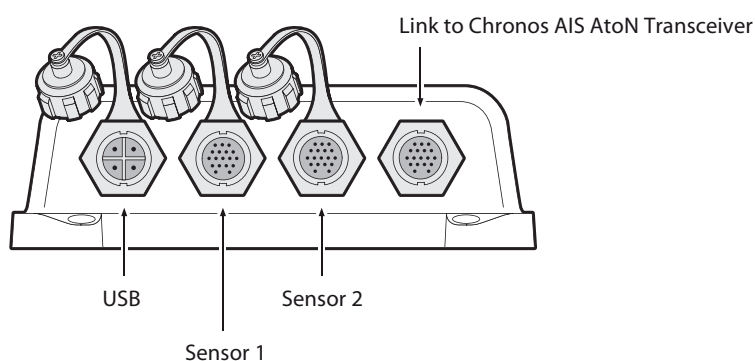

### Mounting

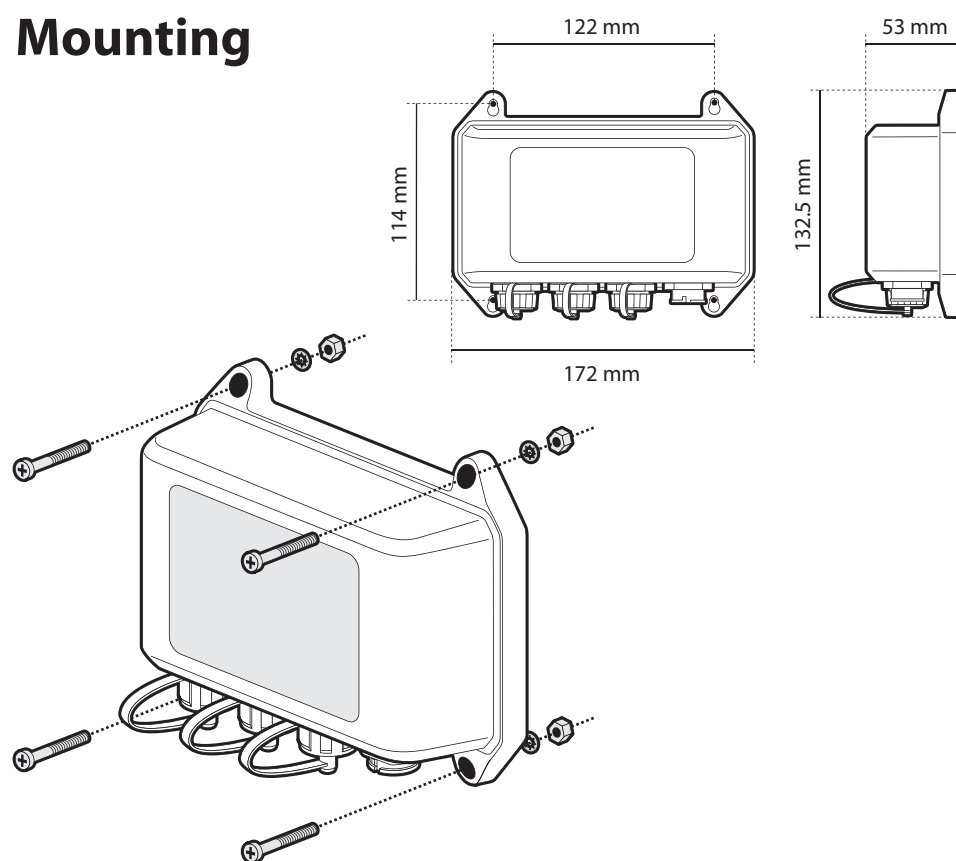

### Installation

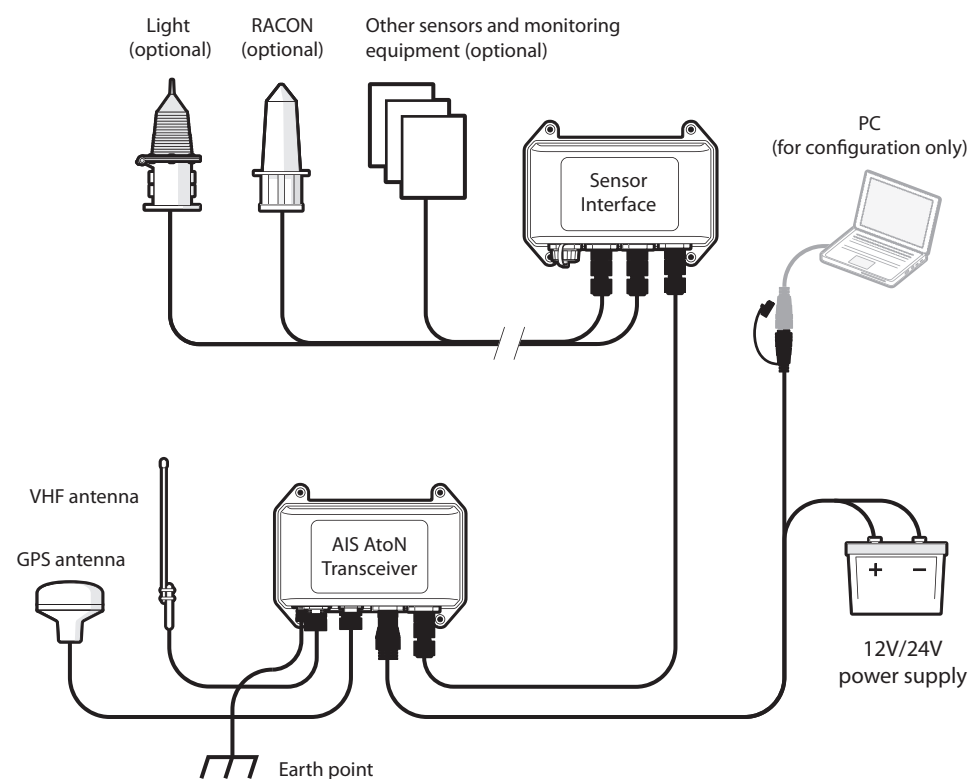

### Important information!



The link connector on the Transceiver cannot be used once the Sensor Interface is connected.

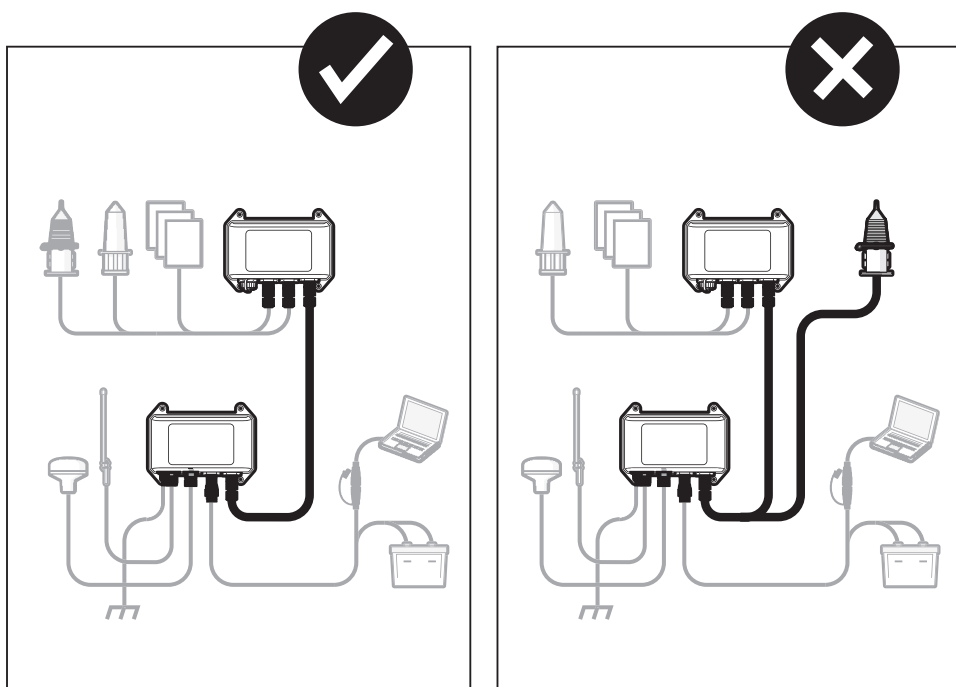

# Wiring the sensor connectors

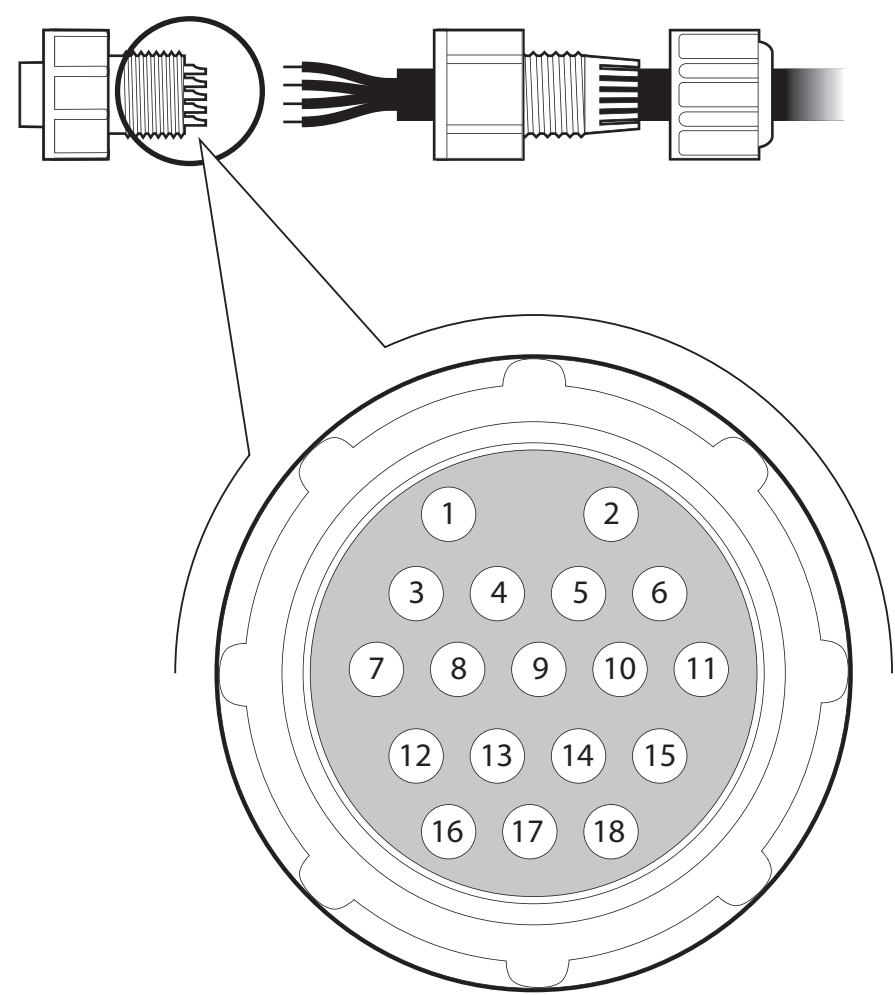

## Pin allocations

Please refer to the user manual for full details of electrical interfacing.

Sensor 1		Sensor 2	
Pin	Function	Pin	Function
1	RS422 TX B	1	Isolated digital interface 1+
2	RS422 RX A	2	Isolated digital interface 1-
3	RS422 TX A	3	Isolated digital interface 2+
4	RS422 RX B	4	Isolated digital interface 2-
5	RS422 GROUND	5	Isolated digital interface 3+
6	RS232 A TX	6	Isolated digital interface 3-
7	RS232 A RX	7	Isolated digital interface 4+
8	RS232 B TX	8	Isolated digital interface 4-
9	RS422 B RX	9	Isolated digital interface 5+
10	SDI-12	10	Isolated digital interface 5-
11	Ground	11	Non isolated digital interface 1
12	Non isolated ADC 1+	12	Non isolated digital interface 2
13	Non isolated ADC 1-	13	Non isolated digital interface 3
14	Non Isolated ADC 2+	14	Ground
15	Non isolated ADC 2-	15	Isolated ADC 1+
16	Current sense +	16	Isolated ADC 1-
17	Current sense -	17	Isolated ADC 2+
18	Relay DR	18	Isolated ADC 2-

# AIS configuration

Refer to the user manual for detailed instructions of how to configure your Chronos Sensor Interface.

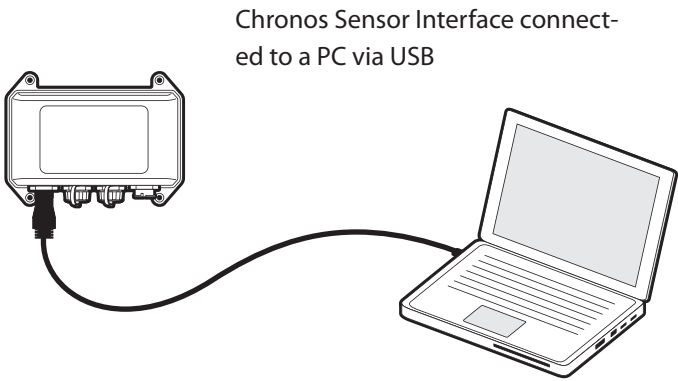

1. Insert the CD into your PC.
2. Navigate to the proAtoN folder and run setup.exe
3. Follow the on-screen instructions.
4. Launch proAtoN from the start menu.
5. Connect Chronos Sensor Interface to the PC via USB.
6. Select the 'AIS AtoN Sensor Port' from the COM port options.
7. Configure the Chronos Sensor Interface for the required sensors.

